

# BackBeat FIT 350 Series









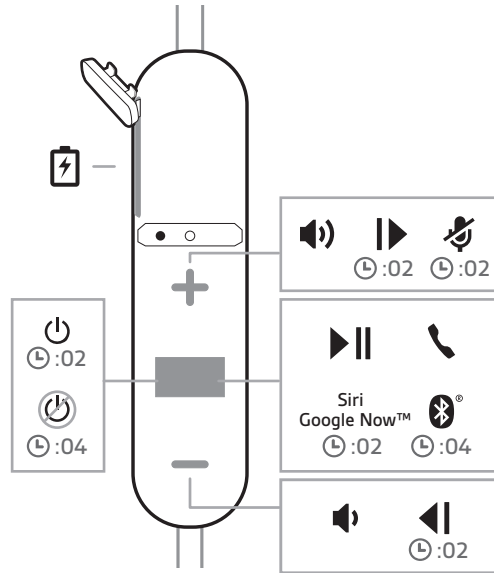

User Guide

# Contents

Headset overview	<b>3</b>
Be safe	<b>3</b>
Install the app	<b>4</b>
Pair	<b>5</b>
Get paired	<b>5</b>
Pair mode	<b>5</b>
Charge and fit	<b>6</b>
Charge	<b>6</b>
Quick charge	<b>6</b>
Fit	<b>6</b>
Wear the headset	<b>7</b>
Basics	<b>8</b>
Power on or off	<b>8</b>
Adjust the volume	<b>8</b>
Music and more	<b>8</b>
Reconnect	<b>8</b>
Answer or end a call	<b>8</b>
Redial	<b>8</b>
Mute the headset	<b>8</b>
Headset Features	<b>9</b>
Voice assistant	<b>9</b>
Answer calls from a second device	<b>9</b>
Voice prompts	<b>9</b>
DeepSleep mode	<b>9</b>
Support	<b>10</b>

# Headset overview



	Charge port
	Power
	Power off
	Volume up
	Track forward
	Mute
	Play/pause
Siri, Google Now™	Voice assistant
	Bluetooth® pairing
	Call answer/end
	Volume down
	Track back

## Be safe

Please read the safety guide for important safety, charging, battery and regulatory information before using your new headset.

# Install the app

Get the most from your headset by downloading our free app, BackBeat for iOS/Android™.

With this app, you can:

- Turn features on/off
- Find MyHeadset
- View the user guide

For maximum benefit, install the BackBeat app on every device paired to the headset.



# Pair

## Get paired

The first time you power on your headset, the pairing process begins.

- 1 Power on the headset by pressing the Center button until you hear "pairing" and the LED light flashes red and blue.

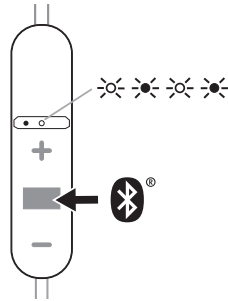

- 2 Activate Bluetooth® on your phone to search for new devices.

- **iPhone** > Settings > Bluetooth > On\*
- **Android** > Settings > Bluetooth > On > Scan\*

**NOTE** \*Menus may vary by device.

- 3 Select "PLT BBFIT350 Series ."  
If necessary, enter four zeros (0000) for the passcode or accept the connection.

Once successfully paired, you hear "pairing successful" and the indicator light stops flashing.

## Pair mode

There are 2 ways to put your headset into pair mode. Choose:

- With the headset powered on, press and hold the Volume up (+) button and Volume down (-) button until you hear "pairing."
- With the headset powered off, press and hold the Center button until you hear "pairing."

**NOTE** You can connect up to 2 devices to your headset.

# Charge and fit

**Charge** The door covering the charging port is located on the left side of the inline controller. Open it with your fingernail. For best performance, fully charge your battery before use.

It takes up to 2 hours to fully charge the headphones from a completely drained battery state. While charging, the indicator light is red and turns off once charging is complete.

**Quick charge** Charge your headset for 15 minutes for up to a full hour of listening time.

**Fit** For the best sound, a good seal with your ear canal is essential. Try on the three different sized eartips to find which one fits you best. You may prefer a different size eartip in each ear for the best fit. The right side eartip notch is larger than the left side eartip.

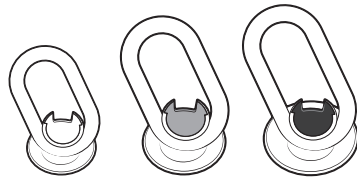

- 1 **Try it out** Put the eartips in your ears and make sure the stabilizing loop is tucked securely in your ear for stability.

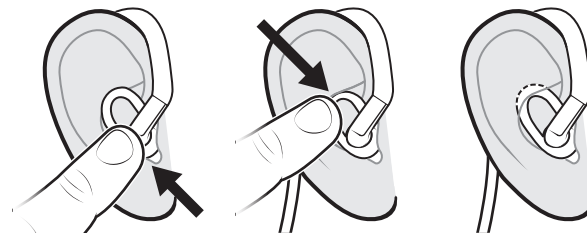

The stabilizing loop should be comfortable once it is tucked securely in your ear.

Listen to a favorite song while trying out each eartip and select the one that gives you the best fit and sound.

- 2 **Remove the eartip** To remove the eartip, pull straight out with some force.
- 3 **Replace the eartip** Push the eartip onto the earbud tip marked with the "L" or "R" with the notch on the rubber eartip lining up with the raised plastic notch in the earbud tip.

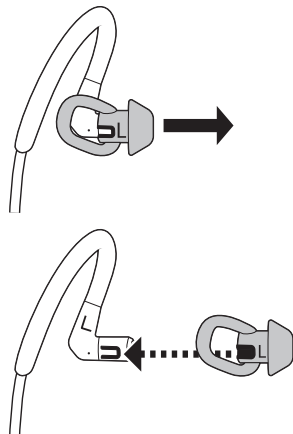

- 4 **Clean the eartip** When needed, clean the eartip with an alcohol wipe or a cotton swab dipped in isopropyl alcohol.

**Wear the headset**

There are 2 ways to use the clothing clip to stabilize your headset.

- **Attach** Drape the headset cord behind your neck and attach the clip to your clothing.

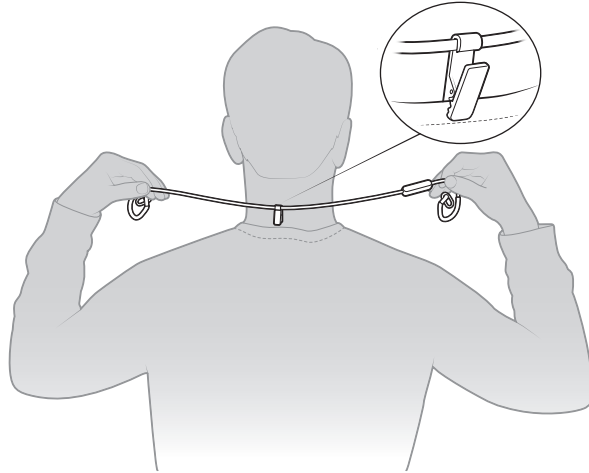

- **Shorten** Cinch the excess cord with the clip.

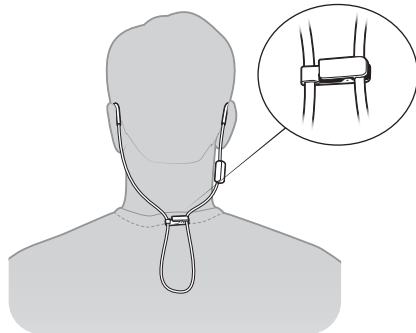

# Basics

## Power on or off

To power on, press the Center button for 2 seconds until you hear "power on." To power off, press the Center button for 4 seconds until you hear "power off."

## Adjust the volume

Tap the Volume up (+) or down (–) button.

## Music and more

Listen to your music, podcasts, navigation and other streaming audio on your headset.

**NOTE** *Functionality varies by application.*

### Play or pause audio

Tap the Center button.

### Skip to next track

Press the Volume up (+) button for 2 seconds.

### Play previous track

Press the Volume down button until you hear the confirmation tone to restart the current track.

Press the button twice (each press until the confirmation tone sounds) to go to the previous track.

## Reconnect

If your headset loses Bluetooth connection with your phone, it will automatically try to reconnect.

If your headset can't reconnect, tap any key once or manually connect through the phone's Bluetooth. If your headset remains out of range for more than 90 minutes, the DeepSleep mode will activate.

## Answer or end a call

Tap the Center  button.

## Redial

Double-tap the Center  button to call the last number you dialed.

## Mute the headset

During a conversation, press and hold the Volume up button or the Volume down button until you hear "mute on" or "mute off." An alert repeats every 15 minutes when mute is on.



# Headset Features

## Voice assistant

**Siri, Google Now™, Cortana** Press and hold the Center button for 2 seconds until you hear the tone. Wait for the phone prompt to activate voice dialing, search, and other smartphone voice controls.

## Answer calls from a second device

It's easy to answer calls from two devices.

When on a call, you hear a ringtone notification of the incoming call from the second paired device.

To answer a second call from the other device, first tap the Center button to end the current call and tap the Center button again to answer the new call. If you choose to not answer the second call, it will go to voicemail.

## Voice prompts

Your headset tells you about status changes. For example:

"Power on"

"Pairing successful"

"Phone 1 connected"

"No phone is connected"

"Mute on"

## DeepSleep mode

If you leave your headphones powered on but out of range of your paired phone for 90 minutes, your headset conserves its battery power by entering into DeepSleep mode.

Once back in range with your phone, press the Center button  button to exit DeepSleep mode.

# Support

## NEED MORE HELP?

[plantronics.com/support](https://plantronics.com/support)

**Plantronics, Inc.**

345 Encinal Street  
Santa Cruz, CA 95060  
United States

**Plantronics B.V.**

Scorpius 171  
2132 LR Hoofddorp  
Netherlands

© 2018 Plantronics, Inc. Bluetooth is a registered trademark of Bluetooth SIG, Inc. and any use by Plantronics, Inc. is under license. Apple and Siri are trademarks of Apple Inc., registered in the US and other countries. All other trademarks are the property of their respective owners.

Patents pending.

213118-06 (12.18)