

The logo consists of a black square with a smaller black square on top of it, slightly offset to the right. The word "HANNspree" is written in white, sans-serif font across the middle of the squares.

HANNspree

HL326HPB (HSG1347)
LCD Monitor

User's Manual

HANNspree, INC.
www.hannspree.eu

TABLE OF CONTENTS

SAFETY NOTICE	5
PRECAUTIONS.....	5
SPECIAL NOTES ON LCD MONITORS	6
BEFORE YOU OPERATE THE MONITOR	7
FEATURES.....	7
CHECKING THE CONTENTS OF THE PACKAGE	7
INSTALLATION INSTRUCTIONS	8
POWER.....	8
SETTING THE MONITOR ON THE WALL	9
MAKING CONNECTIONS.....	10
OPERATING INSTRUCTIONS	11
GENERAL INSTRUCTIONS.....	11
FRONT PANEL CONTROL	12
REMOTE CONTROL.....	13
HOW TO ADJUST A SETTINGS	14
PLUG AND PLAY.....	16
TECHNICAL SUPPORT (FAQ)	17
Q & A FOR GENERAL PROBLEMS	17
ERROR MESSAGE & POSSIBLE SOLUTIONS	19
APPENDIX	21
SPECIFICATIONS.....	21

Before operating the monitor, please read this manual thoroughly. This manual should be retained for future reference.

FCC Class B Radio Frequency Interference Statement

This equipment has been tested and found to comply with the limits for a Class B digital device, pursuant to Part 15 of the FCC Rules. These limits are designed to provide reasonable protection against harmful interference in a residential installation. This equipment generates, uses and can radiate radio frequency energy, and if not installed and used in accordance with the instructions, may cause harmful interference to radio communications. However, there is no guarantee that interference will not occur in a particular installation. If this equipment does cause harmful interference to radio or television reception, which can be determined by turning the equipment off and on, the user is encouraged to try to correct the interference by one or more of the following measures:

- Reorient or relocate the receiving antenna.
- Increase the separation between the equipment and receiver.
- Connect the equipment into an outlet on a circuit different from that to which the receiver is connected.
- Consult the dealer or an experienced radio/TV technician for help.

The device complies with Parts 15 of the FCC Rule. Operation is subject to the following two conditions: (1) this device may not cause harmful interference; and (2) this device must accept any interference received, including interference that may cause undesired operations.

CANADA

This Class B digital apparatus meets all requirements of the Canadian Interference-Causing Equipment Regulation.

【Optional, depend on selected model】



This device complies with requirement of EMC directive 2014/30/EU with regard to Electromagnetic Compatibility, and 2014/35/EU and 93/68/EEC with regard to Low Voltage directive.

【Optional, depend on selected model】

Socket-outlet shall be near the equipment and shall be accessible.

Trademark Notice:

HDMI HANNspree products incorporate High-Definition Multimedia Interface (HDMI™) technology.

The terms HDMI and HDMI High-Definition Multimedia Interface, and the HDMI Logo are trademarks or registered trademarks of HDMI Licensing LLC in the United States and other countries.

RECYCLING INFORMATION

We, the **HANNspree** care very much about our environment protection strategy and firmly believe that it helps us have healthier earth via appropriate treatment and recycling of industrial technology devices at the end-of-life.

These devices contain recyclable materials, which can be re-decomposed and re-integrated into brand-new marvels. On the contrary, other material can be classified to hazardous and poisoned substances. We strongly encourage you to contact the provided information to recycle this product.

For more information, please visit
<http://www.hannspree.eu/>

SAFETY NOTICE

1. The changes or modifications not expressly approved by the party responsible for compliance could void the user's authority to operate the equipment.
2. Shielded interface cables and AC power cord, if any, must be used in order to comply with the emission limits.
3. The manufacturer is not responsible for any radio or TV interference caused by unauthorized modification to this equipment. It is the responsibilities of the user to correct such interference.
4. Only use attachments/accesories specified by the manufacturer.

WARNING:

To prevent fire or shock hazard, do not expose the monitor to rain or moisture. Dangerously high voltages are present inside the monitor. Do not open the cabinet. Refer servicing to qualified personnel only.

PRECAUTIONS

- Do not use the monitor near water, e.g. near a bathtub, washbowl, kitchen sink, laundry tub, swimming pool or in a wet basement.
- Do not place the monitor on an unstable cart, stand, or table. If the monitor falls, it can injure a person and cause serious damage to the appliance. Use only a cart or stand recommended by the manufacturer or sold with the monitor. If you mount the monitor on a wall or shelf, use a mounting kit approved by the manufacturer and follow the kit instructions.
- Slots and openings in the back and bottom of the cabinet are provided for ventilation. To ensure reliable operation of the monitor and to protect it from overheating, be sure these openings are not blocked or covered. Do not place the monitor on a bed, sofa, rug, or similar surface. Do not place the monitor near or over a radiator or heat register. Do not place the monitor in a bookcase or cabinet unless proper ventilation is provided.
- The monitor should be operated only from the type of power source indicated on the label. If you are not sure of the type of power supplied to your home, consult your dealer or local power company.
- Unplug the unit during a lighting storm or when it will not be used for long period of time. This will protect the monitor from damage due to power surges.
- Do not overload power strips and extension cords. Overloading can result in fire or electric shock.
- Never push any object into the slot on the monitor cabinet. It could short circuit parts causing a fire or electric shock. Never spill liquids on the monitor.
- Do not attempt to service the monitor by yourself; opening or removing covers can expose you to dangerous voltages and other hazards. Please refer all servicing to qualified service personnel.
- The wall socket shall be installed near the equipment and shall be easily accessible.

SPECIAL NOTES ON LCD MONITORS

The following symptoms are normal with LCD monitor and do not indicate a problem.

- Due to the nature of the fluorescent light, the screen may flicker during initial use. Turn off the Power Switch and then turn it on again to make sure the flicker disappears.
- You may find slightly uneven brightness on the screen depending on the desktop pattern you use.
- The LCD screen has effective pixels of 99.99% or more. It may include blemishes of 0.01% or less such as a missing pixel or a pixel lit all of the time.
- Due to the nature of the LCD screen, an afterimage of the previous screen may remain after switching the image, when the same image is displayed for hours. In this case, the screen is recovered slowly by changing the image or turning off the Power Switch for hours.
- If the screen suddenly flashes erratically or the backlighting fails, please contact your dealer or service center for repair. Do not attempt to repair the monitor yourself.

BEFORE YOU OPERATE THE MONITOR

FEATURES

80,0cm / 31.5" Wide Screen TFT Color LCD Monitor
GP Green Product
Ergonomic Design
Space Saving, Compact Case Design

CHECKING THE CONTENTS OF THE PACKAGE

The product package should include the following items:

LCD Monitor

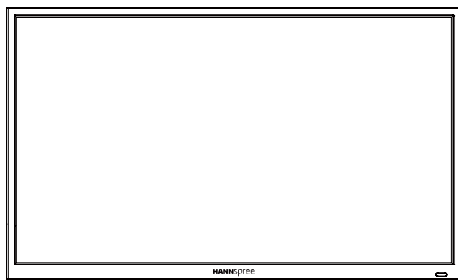

Screen

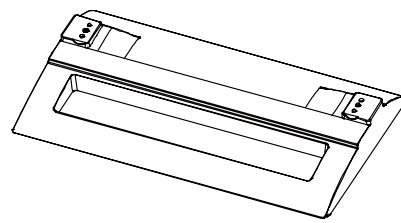

Base

Cables and User manual



Warranty Card



Quick Start Guide



X4

Screws



X2

Battery



Remote Control



UM

INSTALLATION INSTRUCTIONS

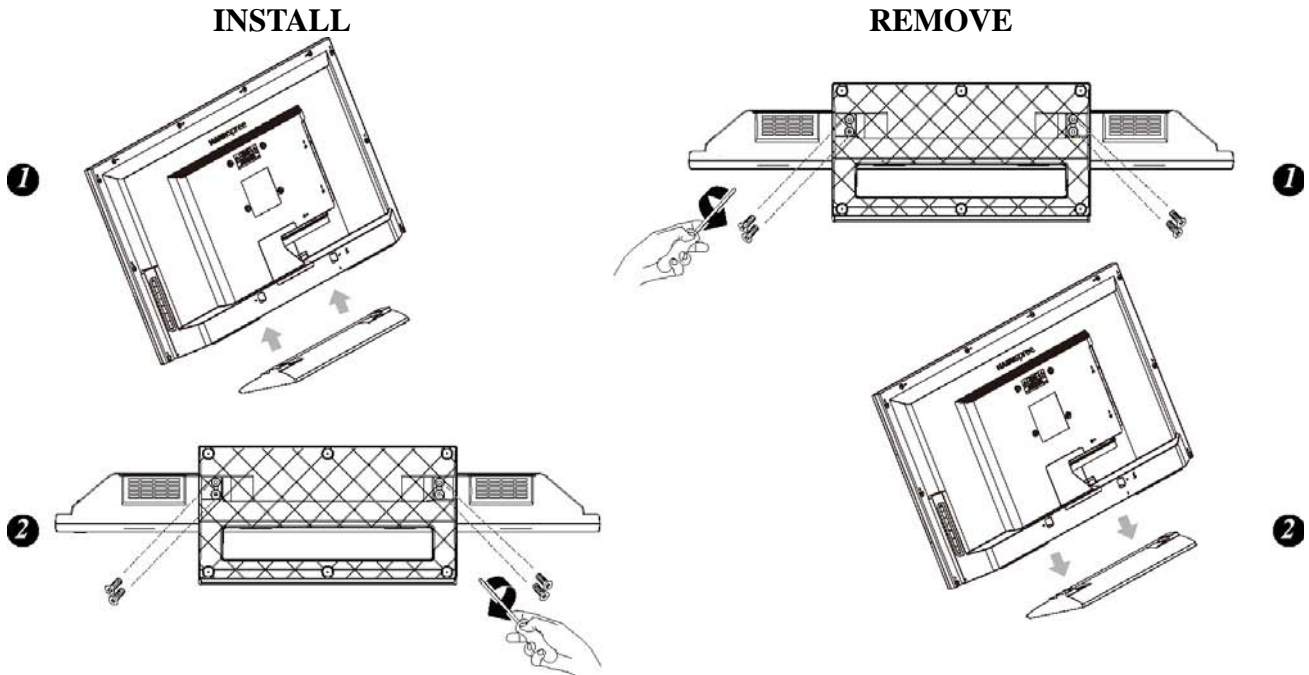

Figure.1. Installing and Removing the Base

INSTALLATION:

1. Align the monitor with the opening in the base.
2. Note that the longer section of the base points forward.
3. Snap the monitor into its base. A clear click sound will affirm that the base is connected correctly.
4. Verify that the monitor is securely attached to the base by looking at the bottom of the base and making sure that the clips are fully engaged in the base.

REMOVAL:

1. Flip over the monitor so that it is upside down.
2. Press the button on the arm that holds the monitor in place.
3. Gently pull the base from the monitor until they are unattached.

POWER

POWER SOURCE:

1. Make sure that the power cord is the correct type required in your area.
2. This LCD monitor has an Internal universal power supply that allows operation in either 100/120V AC or 220/240V AC voltage area (No user adjustment is required.)
3. Connect the AC-power cord one end to your LCD monitor's AC-input socket, the other end to wall-outlet.

SETTING THE MONITOR ON THE WALL

DISSEMBLING THE STAND BASE:

1. Disconnect all the cables and cords from the Monitor to prevent breakage.
2. Carefully place the Monitor face down on a soft and flat surface (blanket, foam, cloth, etc) to prevent any damage to the Monitor.
3. Remove the screws so that the stand base can be removed.
4. Gently remove the stand base.

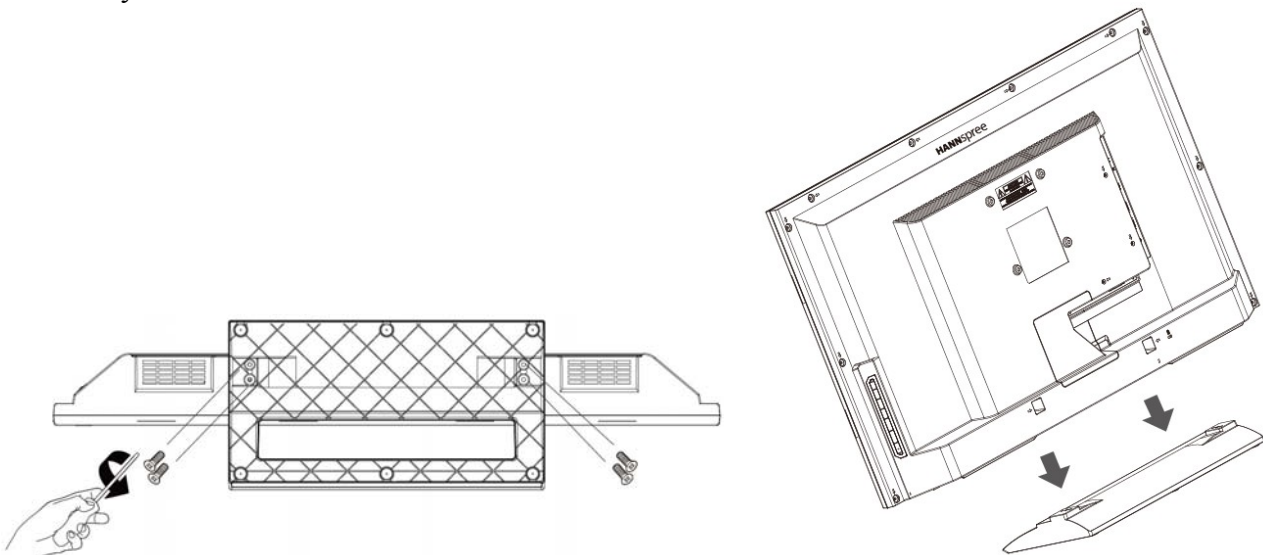

(For reference only)

WALL MOUNTING THE MONITOR:

1. Purchase a VESA compatible wall bracket:
VESA 100×100, 4 holes, M4, 10mm, 8kg.
2. Locate your ideal Monitor position on the wall.
3. Fix the wall bracket firmly on the wall.
4. Secure the Monitor to the bracket using the 4 mount holes on the back and center of the Monitor.

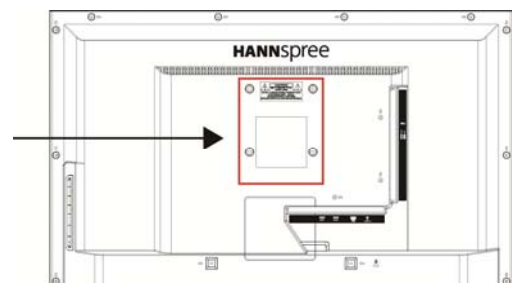

Note:

- Please read the instructions of your specific wall bracket to properly wall mount the Monitor.
- The pitch of the mounting holes is 100mm horizontally and 100mm vertically.
- The screws type required is metric: M4, 10mm length.
- The Monitor stand base can be screwed on a table or a hard surface using the hole on the back of the stand base.
- For use only with UL listed wall mount bracket.

**Installing the LCD Monitor requires special skill that should only be performed by qualified service personnel. Customers should not attempt to do the work themselves. HANNspree bears no responsibility for improper mounting or mounting that results in accident or injury. You can ask a qualified service personnel about using an optional bracket to mount the Monitor to the wall.*

MAKING CONNECTIONS

CONNECTING TO A PC

Turn off your computer before performing the procedure below.

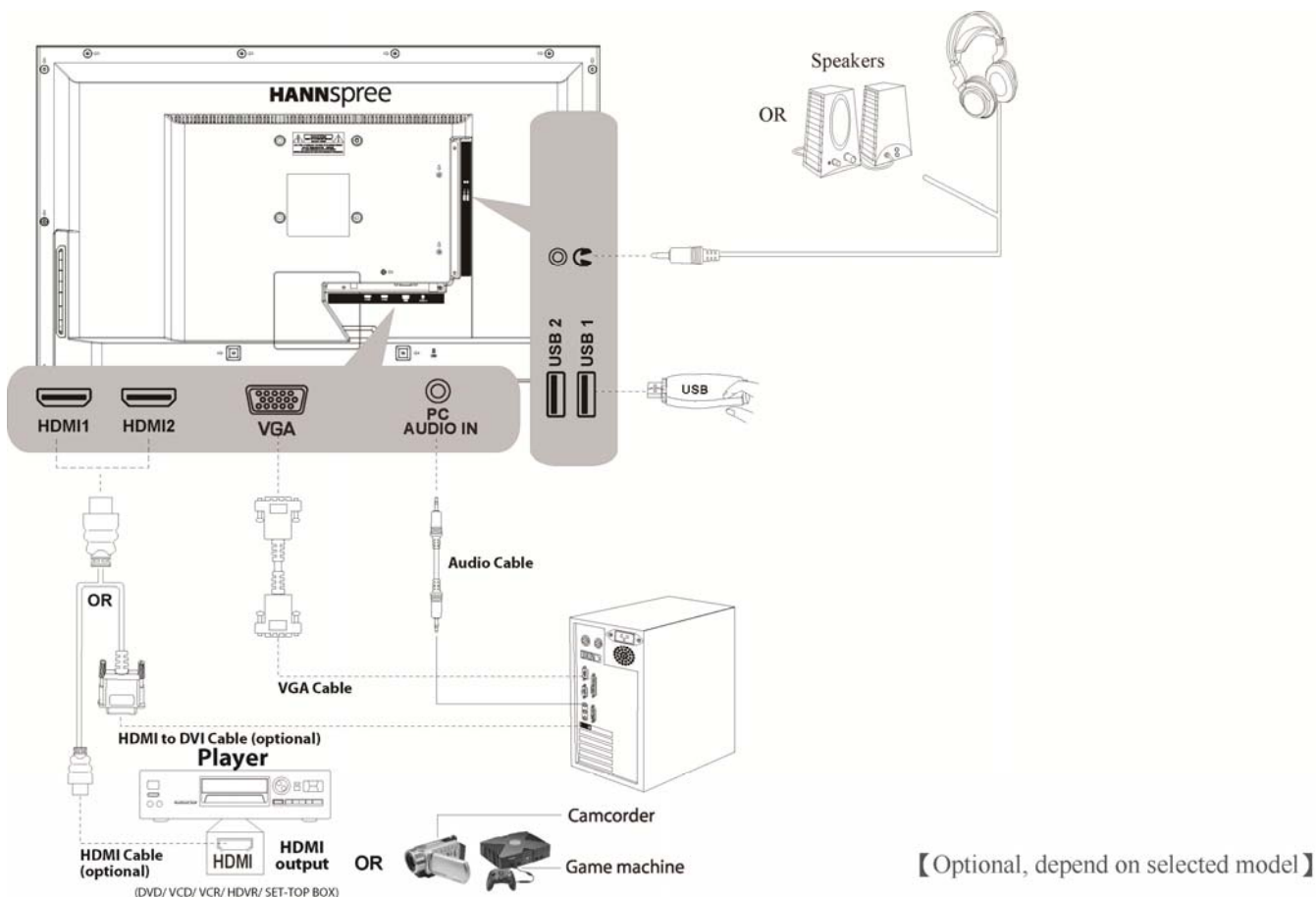







OPERATING INSTRUCTIONS

GENERAL INSTRUCTIONS

Press the power button to turn the monitor on or off. The other control buttons are located on the front panel of the monitor. By changing these settings, the picture can be adjusted to your personal preferences.

- The power cord should be connected.
- Connect the Signal cable from the monitor to the VGA card.
- Press the power button to turn on the monitor. The power indicator will light up.

	Press VOL + to increase volume.
	Press VOL - to decrease volume.
	Press ▲ to Adjust a Function When OSD is Activated.
	Press ▼ to Adjust a Function When OSD is Activated.
	Display the OSD (on screen display) menu
	Press to select among different input signal sources.
	Power Button

FRONT PANEL CONTROL

- **Power Button:**

Press this button to switch ON/OFF of monitor's power.

- **Power Indicator:**

Blue — Power On mode.

Red — Power Saving/Off mode.

- **MENU / RETURN:**

Turn the OSD menu on/off or return to the previous menu.

- **Adjust + / - :**

Adjust Audio volume when the OSD is off.

- **Adjust ▲ ▼ :**

Navigate through adjustment icons when OSD is ON or adjust a function when function is activated.

- **【SOURCE】 Button:**

1. Press **【SOURCE】** to enter Source selections. (Selections include PC, HDMI1, HDMI2 etc. The actual selections may vary depending on the models. This function is only available in models with digital inputs)
2. The OSD menu is used as 《confirmation》 function during start-up.

NOTES:

- Do not install the monitor in a location near heat sources such as radiators or air ducts, or in a place subject to direct sunlight, or excessive dust or mechanical vibration or shock.
- Save the original shipping box and packing materials, as they will come in handy if you ever have to ship your monitor.
- For maximum protection, repackage your monitor as it was originally packed at the factory.
- To keep the monitor looking new, periodically clean it with a soft cloth. Stubborn stains may be removed with a cloth lightly dampened with a mild detergent solution. Never use strong solvents such as thinner, benzene, or abrasive cleaners, since these will damage the cabinet. As a safety precaution, always unplug the monitor before cleaning it.

REMOTE CONTROL

Installing battery

Remove the battery cover, and insert two AAA (1.5V) batteries; make sure that the polarity of the battery is consistent with the marks "+/-" in the battery slot.

Precautions of remote control usage

- Point the remote control to the receiver window. The objects between remote control and the receiver window may disturb the normal operation.
- Keep the remote control away from strong vibration. In addition, do not set or put the remote control in direct sunshine, which may result in deformation of the remote control.
- The remote control may be invalid if the receiver window is in direct sunshine or strong light; in this case, please adjust the angle of the light or the device, or approach the remote control to the receiver window.
- The effective range of the remote control may be affected if the battery voltage is low; in this case, please replace with a new battery; if the remote control won't be used or battery voltage is too low, please take out the battery to avoid corrosion due to battery liquid leakage.
- Do not mix different types of batteries, or used and new batteries.
- Do not throw the batteries into fire, charge or break up, or charge, short circuit, disassemble, heat or burn the used batteries. Please follow the environmental protection regulations to disposal of the batteries.

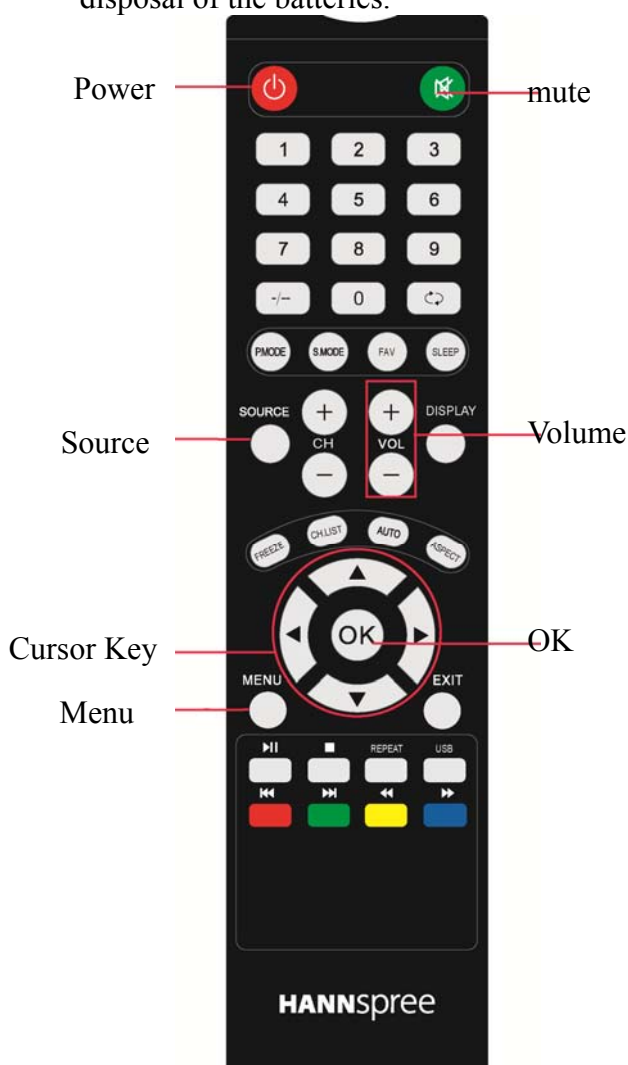

Remote Control Key Instruction

Key	Function
POWER(⏻)	Switch between normal working and standby
MUTE(🔇)	Turn off the sound
▲/▼/◀/▶	▲/▼: select functions; ◀/▶: adjust the analog value
VOL+/VOL-	Turn up/down the volume
MENU	Press this key to call out the main menu
SOURCE	Press this key to display signal source selection menu
∧∨	select functions

HOW TO ADJUST A SETTINGS

Press "MENU" key on the remote control or on the control panel, then the monitor will display the main menu.

1. Press "◀/▶" key on the remote control or "▲/▼" key on the control panel to select the adjustment sort menu, which includes 4 sorts: SCREEN, PICTURE, SOUND, TIME, OPTION.
2. Press "▲/▼" key on the remote control or "▲/▼" key on the control panel to select what is needed to adjust in sort menu.

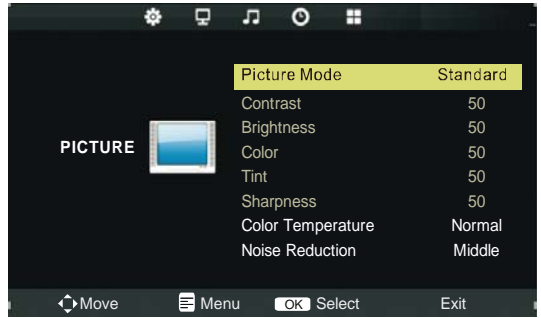



3. Press "◀/▶" key on the remote control or "Vol+/Vol-" key on the control panel to adjust the value or setting.

4. When the main menu appears on the screen, press "MENU" key to exit; when submenu appears on the screen, press "Exit" key to return to previous menu; press "SOURCE" key to show the signal source selection menu, and press it again to exit from the menu.

5. In the process of menu operation, the unavailable options in current state will be in gray.

Note: "◀", "▶", "▲" and "▼" in this Manual stand for the direction cursor keys on the remote control unless specifically defined. The operating instructions in the text below are all based on keys on the remote control. Please understand the keys on the panel by yourself.

 PICTURE			
Item	Function	Operation	Range
Picture mode	Select your viewing preference from 4 options. (TIPS: You can press PMODE button to change the Picture Mode directly.)	Press ▲ or ▼ to highlight an item, press OK or ▶ button to enter submenu.	<ul style="list-style-type: none"> • Dynamic • Standard • Mild • User
Contrast	Adjust the highlight intensity of the picture, but the shadow of the picture is invariable.		0-100
Brightness	Adjust the visual perception output of the entire picture, it will effect the liuminousness of the picture.		0-100
Color	Control the colour.		0-100
Sharpness	Increase this setting to see crisp edges in the picture; decrease it for soft edges.		0-100
Color Temperature	Cycle among color temperature display modes: Cool/Medium/Warm.		<ul style="list-style-type: none"> • Cool • Medium • Warm
Noise Reduction	Enter the Noise Reduction to select :Off/Low/Middle/High.		<ul style="list-style-type: none"> • Off • Low • Middle • High

 SOUND			
Item	Function	Operation	Range
Sound mode	Selects a sound type when viewing programs or videos that support multiple sounds. *TIPS: You can press SMODE button on the remote control to change the Sound Mode directly.	Press ▲ or ▼ to highlight an item, press OK or ► button to enter submen.	<ul style="list-style-type: none"> • Standard • Music • Movie • User
Treble	Increase or decrease the level of the higher-pitched sounds.		0~100
Bass	Increase or decrease the level of the lower-pitched sounds.		0~100
Balance	Adjust the audio output between the left and the right speakers.		0~50
Auto Volume	Allow to select the Auto Volume: On, Off.		On / Off

 TIME			
Item	Function	Operation	Range
Sleep Timer	Use ◀/▶ buttons to select a period of time after which the HE325UPB automatically switches to standby mode:off,10,20,30,60,90,120,180,240(min)	Press ▲ or ▼ to highlight an item, press OK or ◀▶ button to enter submenu.	off,10,20,30,60,90,120,180,240
Auto Sleep	Enter the Auto Sleep to select :Off/3H/4H/5H.		<ul style="list-style-type: none"> • Off • 3H • 4H • 5H
OSD Timer	Allow selection of the display time of the on-screen menu.		5s,10s,15s,20s,25s,30s

 OPTION			
Item	Function	Operation	Range
OSD Language	Select an OSD menu language can be displayed.	Press ▲ or ▼ to highlight an item, press OK or ► button to enter submen.	
Aspect Ratio	Allow to select the option of Aspect Ratio: 4:3, 16:9, Zoom1, Zoom2, Full.		<ul style="list-style-type: none"> • 4:3 • 16:9 • Full
Blue Screen	Allow to select the option of Blue Screen: On, Off.		On / Off

Key Lock	Allow to select the key lock: On, Off.		On / Off
Reset	Allow you to restore the factory settings.		
Software Update(USB)	Allow you to update software using USB.		



SCREEN

Item	Function	Operation	Range
Auto Adjust	Press ▼ / ▲ button to select Auto Adjust, then press OK button to auto adjust		
Horizontal Pos.	Press ▼ / ▲ button to select Horizontal Pos., then press OK button to enter sub-menu. Press ◀ / ▶ button to adjust the horizontal position of image.	Press▲or▼to highlight an item, press OK or ▶ button to enter submen.	0~100
Vertical Pos.	Press ▼ / ▲ button to select Vertical Pos., then press OK button to enter sub-menu. Press ◀ / ▶ button to adjust the vertical position of image.		0~100
Clock	Press ▼ / ▲ button to select Clock, then press OK button to enter sub-menu. Press ◀ / ▶ button to adjust the clock.		0~100
Phase	Press ▼ / ▲ button to select Phase, then press OK button to enter sub-menu. Press ◀ / ▶ button to adjust the phase.		0~100

PLUG AND PLAY

Plug & Play DDC2B Feature

This monitor is equipped with VESA DDC2B capabilities according to the VESA DDC STANDARD. It allows the monitor to inform the host system of its identity and, depending on the level of DDC used, communicate additional information about its display capabilities. The DDC2B is a bidirectional data channel based on the I²C protocol. The host can request EDID information over the DDC2B channel.

THIS MONITOR WILL APPEAR TO BE NON-FUNCTIONAL IF THERE IS NO VIDEO INPUT SIGNAL. IN ORDER FOR THIS MONITOR TO OPERATE PROPERLY, THERE MUST BE A VIDEO INPUT SIGNAL.

TECHNICAL SUPPORT (FAQ)

Q & A FOR GENERAL PROBLEMS

Problem	Reason	Solution
screen display, no sound, indicator is off.	Power plug is loose, or power supply isn't connected.	Check if the power cord is connected properly.
Image has no color.	1. Saturation is too low. 2. Color system is improper.	1. Enter "PICTURE" setting to increase the saturation.
Monitor doesn't have sound.	1. Volume is too low. 2. Sound is turned off. 3. Sound system is improper.	1. Adjust the volume properly. 2. Press the Mute key on the remote control to turn on the sound. 3. Enter "Auto Volume" setting change the sound system.
PC doesn't have display, no signal input.	Signal cable is loose or falls off.	Check whether the signal cable is loose or falls off and reconnect the cable.
Remote control distance becomes short, out of control.	1. The receiver window is blocked. 2. Battery voltage of the remote control is too low.	1. Move the object to avoid blocking the receiver window. 2. Replace the battery.
PC display is blurry.	1. Adjustment is improper. 2. Display mode is improper	1. Use automatic adjustment. 2. Use recommended mode.
PC image offset, can't fit the screen or beyond the screen.	1. Adjustment is improper. 2. Display mode is improper.	1. Use automatic adjustment. 2. Enter "SCREEN" to adjust the vertical or horizontal position. 3. Use recommended mode.
Can't operate the device.	External factors, such as lightning and ESD, may interfere with the normal operation.	Disconnect the power supply first, and connect the power supply after about 1-2 minutes, then turn on the Monitor again.

Addendum related to Windows 7/ Windows 8

When you encounter display problem under Windows 7/ Windows 8, you need to do the following:

1. Make sure your PC computer (Hardware requirement) can support Windows 7/ Windows 8.
2. Make sure your video card can run Windows 7/ Windows 8.
3. If your video card can support Windows 7/ Windows 8, need to install the latest Windows 7/ Windows 8 driver of your video card.

Suggest to do the following:

1. Install the latest Windows 7/ Windows 8 video driver of your video card.
2. Try to use the recommended display resolution that is supported by the monitor.
3. If the recommended display resolution is not working, try the second recommended display resolution.

	1	2
35,56cm / 14" (16:9)	1366×768@60Hz	1366×768@50Hz
39,6cm / 15.6" (16:9)	1366×768@60Hz	1366×768@75Hz
40,64cm / 16" (16:9)	1366×768@60Hz	1366×768@50Hz
43,2cm / 17" (16:10)	1440×900@60Hz	1440×900@75Hz
47cm / 18.5" (16:9)	1366×768@60Hz	1366×768@75Hz
48,3cm / 19" (5:4)	1280×1024@60Hz	1280×1024@75Hz
48,3cm / 19" (16:10)	1440×900@60Hz	1440×900@75Hz
51cm / 20" (16:9)	1600×900@60Hz	1600×900@50Hz
56cm / 22" (16:10)	1680×1050@60Hz	1680×1050@50Hz
54,6cm / 21.5" (16:9)	1920×1080@60Hz	1920×1080@50Hz
58,4cm / 23" (16:9)		
60cm / 23.6" (16:9)		
62,5cm / 24.6 (16:9)	1920×1200@60Hz	1920×1200@50Hz
70cm / 27.5" (16:10)		

And if you still have display problem after doing the above procedure, please visit Hanns.G support and Service Website: <http://www.hannspree.eu/en/monitors>.

Windows is a registered trademark of Microsoft Corporation.

ERROR MESSAGE & POSSIBLE SOLUTIONS

- **CABLE NOT CONNECTED:**

1. Check that the signal-cable is properly connected, if the connector is loose, tighten the connector's screws.
2. Check the signal-cable's connection pins for damage.

- **INPUT NOT SUPPORT:**

Your computer has been set to unsuitable display mode, set the computer to display mode given in the following table.

FACTORY PRESET TIMING TABLE:

MODE	RESOLUTION	HORIZONTAL FREQUENCY (KHz)	VERTICAL FREQUENCY (Hz)
1	640×480 @60Hz	31.469	59.940
2	640×480 @72Hz	37.861	72.809
3	640×480 @75Hz	37.500	75.000
4	800×600 @56Hz	35.156	56.250
5	800×600 @60Hz	37.879	60.317
6	800×600 @72Hz	48.077	72.188
7	800×600 @75Hz	46.875	75.000
8	832×624 @75Hz	49.725	75.000
9	1024×768 @60Hz	48.363	60.004
10	1024×768 @70Hz	56.476	70.069
11	1024×768 @75Hz	60.023	75.029
12	1152×870 @75Hz	68.681	75.062
13	1152×864 @75Hz	67.500	75.000
14	1280×1024 @60Hz	63.981	60.020
15	1280×1024 @75Hz	79.976	75.025
16	1680×1050 @60Hz	65.290	59.954
17	1920×1080 @60Hz	67.500	60.000

(Video mode)

MODE	RESOLUTION
1	720×480i@60Hz
2	720×480p@60Hz
3	720×576i@50Hz
4	720×576p@50Hz
5	1280×720p@50Hz
6	1280×720p@60Hz
7	1920×1080i@50Hz
8	1920×1080i@60Hz

9	1920×1080p@50Hz
10	1920×1080p@60Hz

** We ensure that the monitor can be lighted under interlace signal mode, but we can not guarantee the image quality.

APPENDIX

SPECIFICATIONS

LCD Panel	Driving system	TFT Color LCD
	Size	80cm / 31.5" Diagonal
	Pixel pitch	0.121mm(H) × 0.364mm(V)
Video	H-Frequency	30KHz – 82KHz
	V-Frequency	55Hz – 75Hz
Display Colors		16.7M Colors
Max. Resolution		1920 × 1080 @60Hz
Plug & Play		VESA DDC2B™
Power consumption	ON Mode	50W (Typical)
	Power Saving Mode	≤0.5W
	OFF Mode	≤0.5W
Audio output		Rated Power 6Wx2 rms (Per channel)
Input Terminal		VGA HDMI PC Audio IN USB
Maximum Screen Size		Hor. : 376.32 mm Ver. : 301.056 mm
Power Source		100–240V ~1.2A 50–60Hz
Environmental Considerations		Operating Temp: 0° to 40°C Storage Temp.: -20° to 60°C Operating Humidity: 20% to 85%
Dimensions		407.1 (W)×406.9(H)×179.8(D) mm 16.0"(W)×16.0"(H)×7.1"(D)
Weight (NW)		3.0 kg (6.6 lb)

*** The above specification is subject to actual product specification and is subject to change without prior notice.

NOTES:

The Maximum Resolution will depends on the display card supporting. Related issue can refer to <http://www.hannspree.eu/en/monitors> FAQ section.

HANN
sporee