



JLAB AUDIO
JBUDS PRO
EARBUDS

We love that you are rocking JLab Audio!
We take pride in our products and fully stand behind them.



YOUR WARRANTY

All warranty claims are subject to JLab Audio authorization and at our sole discretion. Retain your proof of purchase to ensure warranty coverage.



CONTACT US

Reach out to us at support@jlabaudio.com or visit jlabaudio.com/contact

REGISTER TODAY

jlabaudio.com/register

Product updates | How-to tips
FAQs & more

INSTRUCTIONS FOR USE

- 1 Lower the volume on your audio device.
- 2 Gently insert the earbuds into your ears.
- 3 Gradually raise the volume to a comfortable level.
- 4 In order to block outside noise, position the earbuds so they form a seal inside your ear.
- 5 Test the various gel tip options to find the best fit.

ADJUSTABLE TIP PLACEMENT

- 1 Choose your tip size.
- 2 Adjust the position.



CUSH FIN PLACEMENT

- 1 Select tip and Cush Fin.
- 2 Rotate Cush Fin.
- 3 Lock in Cush Fin.

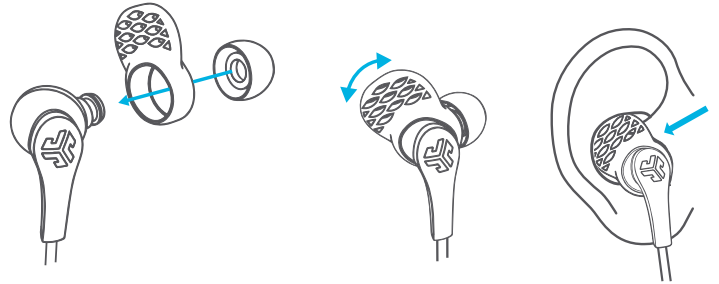

MICROPHONE + BUTTON FUNCTIONS



UNIVERSAL MIC
Goes with both Android + Apple

PLAY / PAUSE / ANSWER / HANG UP CALLS: Single click
TRACK FORWARD: Double click
TRACK BACKWARD: Triple click

CAUTIONS

- Avoid getting moisture or liquids into the tip of the earbuds.
- Avoid extreme heat, cold, and humidity.
- Avoid dropping or crushing the earbuds, stressing the cable by rapid pulling or extreme force, or bending the cable at a sharp angle.
- Wax may build up in the earbud tips, lowering the sound quality. Carefully remove the wax with a cotton swab or other small tool to improve the sound quality.
- If you experience discomfort or pain, try lowering the volume or discontinuing use temporarily.
- If you experience regular discomfort while using this product, discontinue use and consult your physician.
- We recommend you treat your earbuds as you would a nice pair of sunglasses and keep them in safe location when not in use.



Shop products | Product alerts | Burn-in your headphones

JLab Audio + Burn-in Tool



JLABAUDIO.COM