

Before You Start

Turn off your modem, if any, and remove the backup battery if it has one.

Hold the antennas from the base and push them fully into the slots.

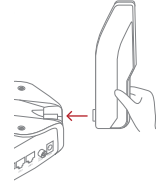

Connect the Hardware

If your internet connection is through an Ethernet cable directly from the wall instead of through a DSL / Cable / Satellite modem, connect the Ethernet cable to the router's Internet port, and then follow steps 3 and 4 to complete the hardware connection.

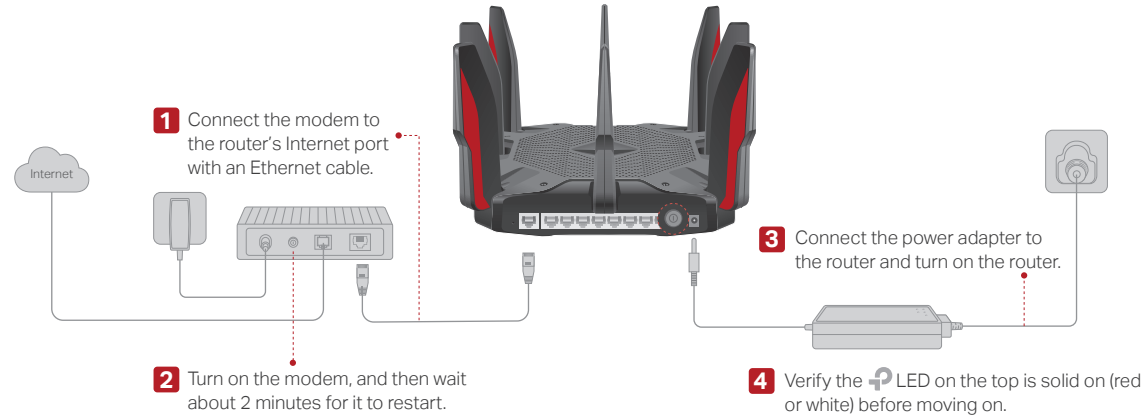

Configure the Router

Method ONE: Via TP-Link Tether App

1. Download the Tether app.

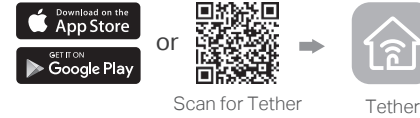

2. Tap the + button in the Tether app and select Archer C5400X. Follow the steps to complete the setup and connect to the internet.

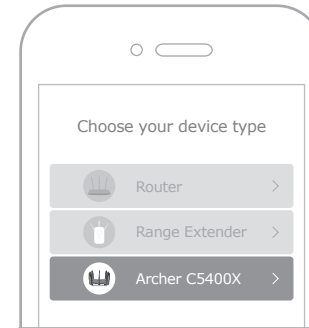

Enjoy the internet !

To enjoy a more complete service from TP-Link, register and bind your TP-Link ID to the router.

Method TWO: Via a Web Browser

1. Connect your device to the router wirelessly or with an Ethernet cable.

The default wireless network names (SSIDs) and password are printed on the label at the bottom of the router.

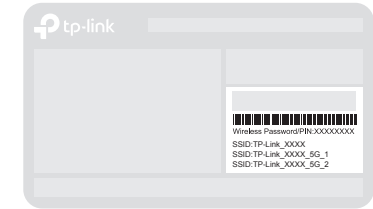

2. Launch a web browser, and enter <http://tplinkwifi.net> or <http://192.168.0.1> in the address bar. Create a password to log in.

Note: If the login window does not appear, please refer to Q1 of Need Help? in this guide.

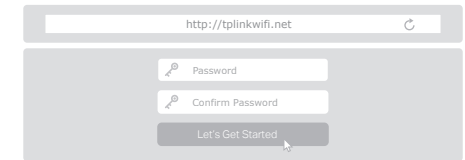

3. Follow the step-by-step instructions to set up the internet connection and register for the TP-Link Cloud service.

LED & Button Explanation



Pulsing orange

The system is starting up.



Solid white

The router is working normally.



Solid Red

No internet connection.



Solid Orange

The router is connected to the internet, but the Wi-Fi is off.



Pulsing white

The firmware is being upgraded, WPS connection is being established or the router is being reset.



WPS Button

Press the WPS button, and immediately press the WPS button on your client to start the WPS process.



Wi-Fi button

Press the Wi-Fi button to turn on or off the wireless function of your router.



LED button

Press the LED button to turn on or off the LEDs of your router.

Need Help?

Q1. What should I do if I can't access the web management page?

- If the computer is set to a static IP, change its settings to obtain an IP address automatically.
- Verify that <http://tplinkwifi.net> is correctly entered in the web browser. Alternatively, enter <http://192.168.0.1> or <http://192.168.1.1> in the web browser.
- Use another web browser and try again.
- Reboot your router and try again.
- Disable and enable the network adapter in use.

Q2. What should I do if I can't access the internet?

- Check if the internet is working normally by connecting a computer directly to the modem via an Ethernet cable. If it is not, contact your internet service provider.
- Log in to the web management page of the router, and go to the **Basic > Network Map** page to check whether the internet IP address is valid or not. If it is, please run the Quick Setup again; otherwise, check the hardware connection.
- Reboot your router and try again.
- For cable modem users, log in to the web management page of the router and go to **Advanced > Network > Internet > MAC Clone**. Select **Use Current Computer MAC Address** and click **Save**. Then reboot both the modem and the router.

Q3. What should I do if the router can't be found via Bluetooth in Tether (how to reset the router)?

The router's Bluetooth will be enabled for 30 minutes following a reset to factory defaults. There are two ways to reset the router:

- With the router powered on, use a pin to press and hold the **Reset** button on the back of the router until the LED blinks.
- Log in to the web management page of the router. Go to **Advanced > System Tools > Backup & Restore**, and click **Factory Restore**. The router will reset and restart automatically.

Quick Installation Guide

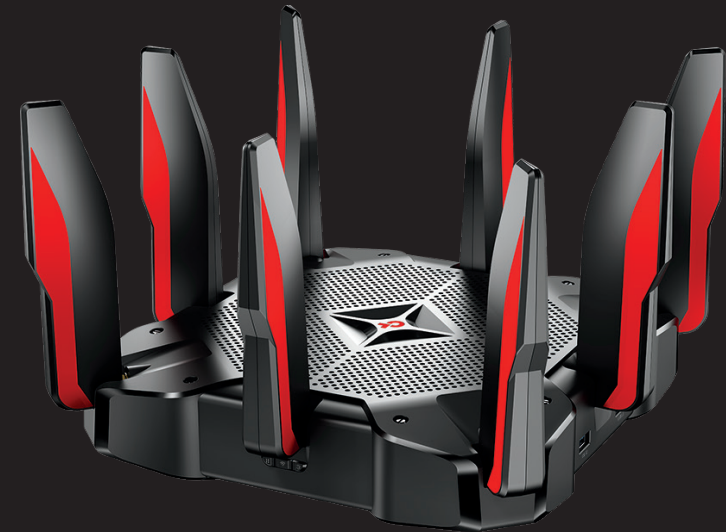

AC5400 MU-MIMO Tri-Band Gaming Router

Archer C5400X



For technical support, User Guide and other information, please visit <http://www.tp-link.com/support>

©2017 TP-Link 7106507832 REV 1.0.1

