

# WorkForce WF-7710DWF

DATASHEET / BROCHURE



Expand your potential with this A3 4-in-1 inkjet. It offers high-quality, low-cost-printing and flexible wireless solutions including NFC<sup>1</sup>.

Think big with this high-quality 4-in-1 with single and double-sided printing, scanning and fax all up to A3. You'll stride through tasks with print speeds of 18ppm<sup>2</sup> in black and a 35 page A3 automatic document feeder (ADF). And that's not forgetting its cost-effective inks and flexible wireless connectivity solutions such as NFC<sup>1</sup> and Scan-to-cloud<sup>3</sup>.

## Professional A3 printing

This A3 4-in-1 printer will meet the needs of even the most demanding home office and small office users. It offers double-sided (duplex) printing, scanning and faxing all up to A3, plus its automatic document feeder can process up to 35 double-sided A3 pages. Furthermore, its PrecisionCore printhead produces high-quality, laser-like prints.

## Enhance your productivity

This efficient, reliable and fast model offers A3 double-sided printing and print speeds of 18ppm in black and 10ppm in colour<sup>2</sup>. It's also simple to operate directly thanks to its intuitive user interface and 10.9cm touchscreen.

## Minimise your outgoings

Dramatically reduce your costs; this printer offers up to 50 percent lower cost-per-page than competitors' laser models<sup>4</sup>. Giving great value for money, cartridges are available in standard, XL and XXL, with the highest yield delivering up to 2,200 pages<sup>5</sup>.

## Flexible wireless solutions

Print from anywhere in the office with Wi-Fi connectivity or use Wi-Fi Direct to print from compatible wireless devices without a Wi-Fi network. You can also print via NFC with a simple tap of a compatible Android device on the printer<sup>1</sup>. Epson's free mobile printing apps and solutions provide further versatility; Email Print allows you to send items to print from almost anywhere in the world<sup>3</sup>. And with Scan-to-Cloud, you can enjoy the benefits of collaborative working<sup>3</sup>.

## KEY FEATURES

- **High-quality A3 4-in-1**  
Double-sided print, scan, copy and fax - all up to A3
- **Fast business-quality printing**  
18ppm in black and 10ppm in colour<sup>2</sup>
- **Cost-effective inks**  
Up to 50% lower cost-per page than competitive lasers<sup>4</sup>
- **Wireless solutions**  
Ethernet, Wi-Fi, Wi-Fi Direct, NFC<sup>1</sup> and Scan-to-Cloud<sup>3</sup>
- **Epson's free mobile printing apps**  
Freedom to print and scan from almost anywhere<sup>3</sup>

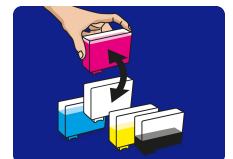

## PRODUCT SPECIFICATIONS

### TECHNOLOGY

Printing Method	PrecisionCore™ Print Head
Minimum Droplet Size	3.8 pl, With Variable-Sized Droplet Technology
Ink Technology	DURABrite™ Ultra

### PRINT

Printing Speed ISO/IEC 24734	18 pages/min Monochrome, 10 pages/min Colour
Duplex Printing Speed ISO/IEC 24734	8.7 A4 pages/min Monochrome, 6 A4 pages/min Colour
Maximum Printing Speed	32 pages/min Monochrome (plain paper), 20 pages/min Colour (plain paper)
Printing Resolution	4,800 x 2,400 dpi
Max Duty cycle	20,000 pages per month
	The maximum number of printed pages per month based on the performance capabilities of the printer, including ISO rated print speeds and paper handling capabilities.
Recommended Duty Cycle	200 - 2,500 pages per month
Colours	Black, Cyan, Yellow, Magenta

For detailed information on printing speeds please visit <http://www.epson.eu/testing>.

### SCAN

Scanning Resolution	1,200 dpi x 2,400 dpi (Horizontal x Vertical)
Output formats	BMP, JPEG, TIFF, multi-TIFF, PDF, searchable PDF, PNG
Scanner type	Contact image sensor (CIS)

### FAX

Fax speed dials (max)	200 names and numbers
Page memory	upto 550 pages/ 6MB (ITU-T No. 1 chart)
Fax Functions	Favorites, PC Fax, Auto Redial, Speed Dial

### PAPER / MEDIA HANDLING

Paper Formats	A3+, A3, A4, A5, A6, B4, B5, C4 (Envelope), C6 (Envelope), DL (Envelope), No. 10 (Envelope), Letter, 9 x 13 cm, 10 x 15 cm, 13 x 18 cm, 16:9, User defined, Legal
Automatic Document Feeder	35 pages
Duplex	Yes (A4/A3, plain paper)
Paper Tray Capacity	250 Sheets Standard, 250 Sheets maximum
Number of paper trays	1

### CONNECTIVITY

Interfaces	Hi-Speed USB - compatible with USB 2.0 specification, Ethernet interface (100 Base-TX / 10 Base-T), Wireless LAN IEEE 802.11b/g/n, Wi-Fi Direct, Near Field Communication (NFC), USB host
WLAN Security	WEP 64 Bit, WEP 128 Bit, WPA PSK (TKIP), WPA PSK (AES)

### GENERAL

Energy Use	19 W (standalone copying, ISO/IEC 24712 pattern), 1.7 W (sleep mode), 8.5 W (Ready), 0.3 W (Power off), ENERGY STAR® qualified
------------	--

### OTHER

Warranty	12 months On-site service Optional warranty extension available
----------	--

## LOGISTICS INFORMATION

SKU	C11CG36411
EAN code	8715946631066
Country of Origin	Indonesia
Layer	2 Units
Layer Block	2 Units

For more information please contact:

Home users: 0343 90 37766  
Business users\*: 0871 42 37766  
Republic of Ireland: 01 436 7742  
Or visit us at <https://www.epson.co.uk/contactus>  
\* 10p per minute plus network extras.

Web: [www.epson.co.uk](http://www.epson.co.uk)  
[www.epson.ie](http://www.epson.ie)

Trademarks and registered trademarks are the property of Seiko Epson Corporation or their respective owners. Product information is subject to change without prior notice.

## WorkForce WF-7710DWF

### WHAT'S IN THE BOX

- Driver and utilities (CD)
- Individual Ink Cartridges
- Main unit
- Power cable
- Quick Start Guide
- Warranty document

### INK YIELD DATA



Alarm clock  
27XL

Alarm clock  
27XXL

● 1,100 pages\* 2,200 pages\*

●●● 1,100 pages\*

\* Approx. page yield based on ISO/IEC 24711/24712 or ISO/IEC 29102/29103. Actual yield will vary depending on images printed and usage conditions. For more information visit <http://www.epson.eu/pageyield>

1. Requires NFC and Wi-Fi Direct enabled device with Android OS 4.0 or higher. Requires download of Epson iPrint app from Google Play.
2. Determined in accordance with ISO/IEC 24734 showing the average of ESAT from the Office Category Test for default A4 simplex. For more information, please visit [www.epson.eu/testing](http://www.epson.eu/testing)
3. Epson iPrint requires a wireless connection and the Epson printing app. Epson Email print, Epson Remote Print Driver and Epson Scan-to-Cloud require an internet connection. For more information, supported languages and devices, please visit [www.epsonconnect.eu](http://www.epsonconnect.eu)
4. For more information visit [www.epson.eu/inkjetsaving](http://www.epson.eu/inkjetsaving)
5. Approx. page yield based on ISO/IEC 24711/24712. Actual yield will vary depending on images printed and usage conditions. For more information visit [www.epson.eu/pageyield](http://www.epson.eu/pageyield)

**EPSON**®