

Helpdesk/Technical Support

Technical Support E-mail: tech@swann.com

Telephone Helpdesk

USA Toll Free 1-800-627-2799

USA Parts & Warranty 1-800-627-2799

(M-F, 9am-5pm US PT)

AUSTRALIA 1800 788 210

NEW ZEALAND Toll Free 0800 479 266

UK 0808 168 9031



Tell us what you think!

We are constantly working to improve the quality of our documentation, and we would appreciate your feedback. You can give us your feedback by clicking [here](#) to complete a short survey.



M1080FLB120416CAM16E | © Swann 2016

Limited Warranty - Terms & Conditions

Swann Communications warrants this product against defects in workmanship and material for a period of one (1) year from its original purchase date. You must present your receipt as proof of purchase for warranty validation. Any unit which proves defective during the stated period will be repaired without charge for parts or labour or replaced at the sole discretion of Swann. The end user is responsible for all freight charges incurred to send the product to Swann's repair centres. The end user is responsible for all shipping costs incurred when shipping from and to any country other than the country of origin.

The warranty does not cover any incidental, accidental or consequential damages arising from the use of or the inability to use this product. Any costs associated with the fitting or removal of this product by a tradesman or other person or any

other costs associated with its use are the responsibility of the end user. This warranty applies to the original purchaser of the product only and is not transferable to any third party. Unauthorized end user or third party modifications to any component will render all warranties void. By law some countries do not allow limitations on certain exclusions in this warranty. Where applicable by local laws, regulations and legal rights will take precedence.

For Australia: Our goods come with guarantees which cannot be excluded under Australian Consumer Law. You are entitled to a replacement or refund for a major failure and for compensation for any other reasonably foreseeable loss or damage. You are also entitled to have the goods repaired or replaced if the goods fail to be of acceptable quality.

5

FCC Verification

This equipment has been tested and found to comply with the limits for Class B digital device, pursuant to part 15 of the FCC Rules. These limits are designed to provide reasonable protection against harmful interference in a residential installation. This equipment generates, uses and can radiate radio frequency energy and, if not installed and used in accordance with the instructions, may cause harmful interference to radio or television reception, which can be determined by turning the equipment off and on, the user is encouraged to try to correct the interference by one or more of the following measures:

- Reorient or relocate the receiving antenna
- Increase the separation between the equipment and the receiver
- Connect the equipment into an outlet on a circuit different from that to which the receiver is connected
- Consult the dealer or an experienced radio/TV technician for help

These devices comply with part 15 of the FCC Rules. Operation is subject to the following two conditions:

- (1) These devices may not cause harmful interference.
- (2) These devices must accept any interference received, including interference that may cause undesired operation.

6



HD Bullet Security Camera

1080p HD Bullet Camera

EN

INSTRUCTION MANUAL

Introduction

Congratulations on your purchase of this HD Bullet Security Camera.

- Use the On-Screen Display (OSD) controller & built-in software to customize the camera settings including color, brightness & wide dynamic range for the best video quality every time
- This camera can be used in combination with other analog surveillance technology including AHD, TVI, CVI from Swann & other brands. It's the perfect addition if you already have a recording solution (DVR) & need extra cameras
- The camera joystick is used to set the signal modes for the camera. Hold for 2 seconds; Up for Analog, Left for AHD, Right for TVI and Down for CVI.

Important note: All jurisdictions have specific laws and regulations relating to the use of cameras. Before using any camera for any purpose, it is the buyer's responsibility to be aware of all applicable laws and regulations that prohibit or limit the use of cameras and to comply with the applicable laws and regulations.

Warning: Modifications not approved by the party responsible for compliance could void user's authority to operate the equipment.

Important safety instructions

- 1) Make sure product is fixed correctly and stable if fastened in place.
- 2) Do not operate if wires and terminals are exposed.

1

Choosing a location for your Camera

This camera has an on-screen configuration menu to configure various image settings as they apply to the camera and the scene that you wish to view.

- You should endeavor to set the camera up close to the area you wish to view before you install the camera so that you have access to the joystick and can adjust the image settings.
- How you're going to connect the camera to your monitoring system; you should plan the route from the recorder to each camera
- How to keep the camera out of harm's way. It's recommended to mount your cameras in an elevated position to prevent easy access.
- Place your camera as close to the area of interest as practicable. The best position is from about 3-4m (9-13ft) above looking slightly down.
- Although the sky looks nice when you look at the live view from your camera, it is an unlikely direction for an offender to approach from. Keep the camera pointed down away from the sky or ceiling. This will also minimize glare from lighting affecting the image.

- Think about the most likely way a potential offender may approach your home and position your cameras to give you the best coverage of these areas.
- The camera's casing is resistant to water, different weather conditions and tampering. However, the cable and connectors are vulnerable and require protection.
- Even though the camera is weather and water-resistant, prolonged exposure to adverse weather conditions such as sunlight or excessive moisture, may eventually damage the internal components of the camera and adversely affect its performance.

Positioning the cables

- 1) When running the cable, try to avoid bending it at sharp angles.
- 2) Avoid positioning the cable live electrical wiring. AC electricity generates radio "noise" which can interfere with the signal from your camera.
- 3) Do not stretch or apply force to the cable greater than 25lbs/11kgs.

2

Connecting your Camera

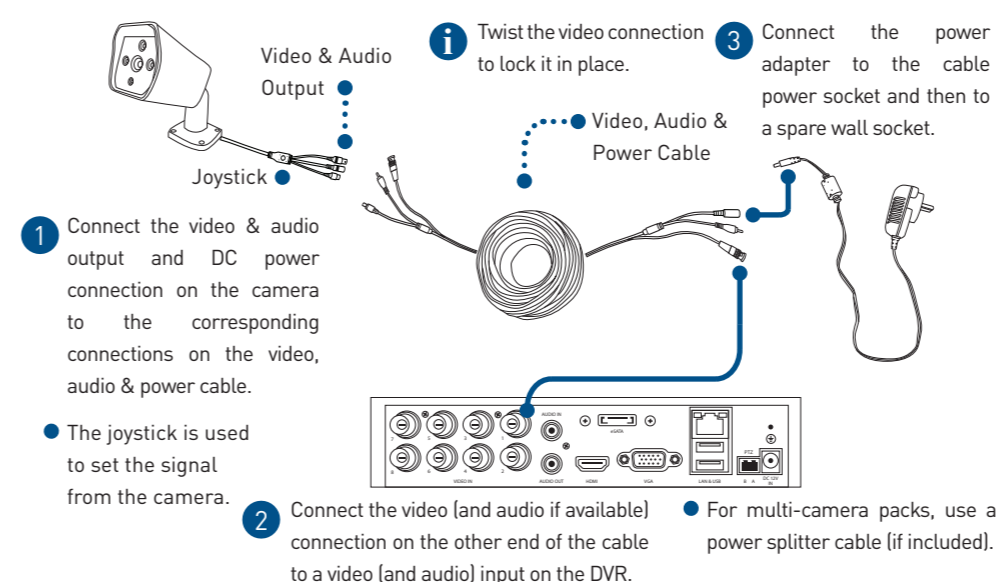

3

Mounting your Camera

The camera can be mounted onto a flat surface using screws. The surface must have sufficient strength to hold the camera.

- Position the camera in the location you want to mount it, and mark the screw holes on the surface to position the screws on the surface. Then, using appropriate screws for the surface you're fixing the camera to, secure the camera into place.
- If you're mounting to a wooden surface, then screw the camera directly to the surface.
- If you're mounting to a masonry surface (bricks, concrete or similar) then you'll need to use the included wall plugs.

Aiming the camera

You can use the included allen key to adjust the camera angle.

- To adjust the orientation, loosen the screw indicated by 1. This enables you to rotate the camera so no matter what direction it is facing, your images will be the right way up.
- To tilt up and down, loosen the indicated by 2.
- To pan left and right, loosen the screw indicated by 3.

Be sure to tighten the screws back securely to lock the camera's position in place after you finish adjusting the camera angle.

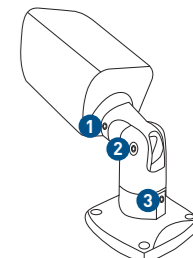

4