



HD 720p Dash Camera with motion detection & 1.5" viewing screen

Contains:

Dash camera, suction cup and arm holder, USB cable, power cable

Diagram



PNGD3

1

MEMORY CARD

1. Insert the Micro SD card into the Micro SD Card slot with the gold contacts facing the display side (compatible with Micro SD Cards 4-32GB - class 10)



NOTES:

- Before inserting or replacing a Micro SD Card, make sure the unit is powered off.
- When inserting the Micro SD Card, make sure it is facing in the proper direction.
- Never force the card in as it may damage the card or the unit. If it doesn't fit easily, check to ensure it is facing in the correct position and that you have the correct type of memory card.
- Please format the memory card prior to the first time using it in this device.

Important: Formatting the Micro SD Card will delete all the files on the card. Upload the files to your computer before formatting the card.

4

RECORDING ADJUSTMENTS:

- To toggle between Night mode and Day mode use the power button in video recording mode. As you change modes, will appear when selecting day mode and will appear when selecting night mode.
- When recording video, press the button to capture video without audio. The will appear on the LCD Display. Press it again to record with audio once again.
- When recording video, press M/⏻(MODE/Lock) button to lock the current file. The will appear on the LCD Display. The locked file cannot be deleted.

SETTING MENU

Video:

1. Press the button to enter the video settings menu.
2. Using the buttons, select and highlight the function you would like to adjust. Press the OK button to enter the subsequent menus.
3. Press button to enter the system settings menu.
4. Press button again to exit the menu interface.
5. Press the OK button to enter or confirm the settings.

VIDEO SETTINGS

Resolution

(To set or reset the resolution of the video)

720p: 1280 x 720 pixels @ 30fps

VGA: 640 x 480 pixels @ 30 fps

Loop recording

Options: OFF; 1; 3; 5; 10

Select 1, 3, 5 or 10 to record video clips for the duration selected. (1 will capture 1 minute clips, 3 will capture 3 minute clips, and so on). The unit will continually create new video clips as it records. Should you run out of space on your memory card, the unit will automatically record over the oldest files by date.

If you set the "Loop recording" option to "OFF", the unit will

7

Preparation

BATTERY OPERATION

The unit has a built-in 3.7V Li-ion rechargeable battery. This battery allows for short-term use (approximately 2.5 minutes for video recording or 4 minutes for video playback).

To charge the built-in battery:

1. Connect the supplied Car Adaptor to the USB Port on the side of the unit.
2. Connect the Car Adaptor into the Car Cigarette Lighter Jack, as illustrated below. The unit will be automatically powered on and switch to recording mode.

Then:

- The LCD display will illuminate.
- The blue power indicator will illuminate and blink.
- The red charging indicator will illuminate.



3. When finished charging, the red charging indicator will turn off. To reduce charging time, press and hold the button to turn off the unit. The LCD Display and blue indicator will not light.

NOTES:

Your battery will last longer if you follow these simple guidelines for caring and storing:

- Before first time use, charge it approximately 30 minutes until the unit is fully charged.
- Recharge and store the unit in an environment that does not exceed the temperature range of 40°F~95°F (5°C~35°C).
- Battery life will naturally drain slowly over time, so be sure to keep the device fully charged.

2

Operation

Car Dash Cam Mode

1. Recharge the built-in battery, as instructed earlier, and connect the supplied power supply to the car's cigarette lighter socket for uninterrupted recording.
2. Mount the unit to the desired location on the car's windshield as instructed earlier.
3. When the unit is plugged in, it will automatically power on when you start your car. At this time the red and blue indicators will illuminate and the unit will enter video recording mode.

NOTES:

- The unit will record video in 1/3/5/10 minute increments. You can choose your desired clip length by changing the "Loop recording" in the unit's video settings menu.
- The unit will continually create new video clips as it records. Should you run out of space on your memory card, the unit will automatically record over the oldest files by date.
- If you set the "Loop recording" option to "OFF", the unit will continually record video until the memory card is full, at which time the unit will stop recording and "SD card full" will appear on the display.

Video Recording:

1. To wake the unit from standby mode, press the power button or simply connect the unit to power source. The unit will automatically enter video recording mode, then:
 - The blue indicator on back of unit will illuminate and blink.
 - A red will appear on LCD Display and blink.
 - The icon will appear on the top left corner of the LCD Display.
2. Pressing the OK button will stop the unit from recording. Then:
 - The blue indicator on front of unit will stop blinking.
 - The red will disappear on LCD Display.
3. Pressing the OK button again will start the unit recording again.
4. To power off, press and hold the power button.

5

continually record video until the memory card is full, at which time the unit will stop recording and "SD card full" will appear on the display.

Exposure

To set or reset the exposure level as desired. This will cause the video to become dark or bright.

Motion Detection

On or Off.

If On is selected, the unit will record a 10 second clip when the sensor detects any movement in front of the unit.

Date Stamp

Set to On or Off as desired. If On is selected, the date and time will be recorded on the video.

Record Audio

Set to On or Off as desired. If set to Off, no sound will be recorded.

SYSTEM SETTINGS

Date/Time

To set or reset time and date.

Auto Power Off

To activate and set the duration time of the auto power off timer or turn it off.

Screen Saver

To activate and set the idle period time of the screen saver or turn it off.

Language

To set or reset the language of the OSD (on screen display).

Frequency

To set or reset the frequency of the AC power to reduce interference (in the USA and Canada, set it to 60Hz).

USB

To set the function to PC Cam or Disk Drive.

Format

This function will format (erase all data) on the Micro SD Card.

- The rechargeable battery installed in this device is not designed to be user replaceable.
- If the unit will not be used for a long period of time, unplug the unit from power source.

SUCTION CUP MOUNTING

To install your Dash Cam, mount the supplied Suction Cup in your car as illustrated below:

1. Install the suction cup to the Dash Cam (see illustrations)
2. Push the suction cup on your windshield, then press the lever on the suction cup to lock it
3. Loosen the plastic nut by turning it counterclockwise. Adjust the angle of the unit as desired then tighten the nut by turning it clockwise
4. To remove the mount from the windshield, lift the lever, then pull back the tab on the suction pad

Illustrations:

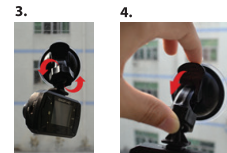
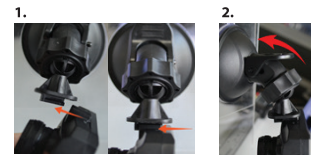

3

Picture Capture Mode:

1. To wake the unit from standby mode, press the power button or simply connect the unit to power source. The unit will automatically enter video recording mode, then:

- The blue indicator on front of unit will illuminate and blink.
 - A red will appear on LCD display and blink.
 - The icon will appear on the top left corner of the LCD Display.
2. Pressing the OK button will stop the unit from recording. Then:
- The blue indicator will stop blinking.
 - The red will disappear on LCD Display.
3. Press the M/⏻(MODE/Lock) button repeatedly until the icon appears on the top left corner of the display to enter photo capture mode.
4. Press and release the OK button once to take a photo.
5. To power off, press and hold the power button.

Playback Mode:

1. Recharge the built-in battery, as instructed earlier.
2. To wake the unit from standby mode, press the power button or simply connect the unit to power source. The unit will automatically enter video recording mode, then:
 - The blue indicator will illuminate and blink.
 - The red will appear on LCD display and blink.
 - The icon will appear on the top left corner of the LCD display.
3. Pressing the OK button will stop the unit from recording. Then:
 - The blue indicator will stop blinking.
 - The red indicator will disappear on LCD display.
4. Press the M/⏻(MODE/Lock) button repeatedly until the icon appears on the top left corner of the display to enter to playback mode.
5. Press the button to select your desired file. If you wish to play a video file, press the OK button to begin playback. The OK / power button also functions as a pause and play button during playback.
6. To power off, press and hold the power button.

6

IMPORTANT: When formatting the card, all files will be erased. Upload all files you would like to save to your PC BEFORE you start to format the card.

Default Setting

Reset all settings to factory preset.

Version

View the firmware version number.

PICTURE SETTINGS

- Enter picture capture mode as instructed earlier (pg 6).
- Press the button to enter the picture settings menu.
- Use the buttons to select and highlight the function you would like to adjust. Press the OK button to enter the subsequent menus.
- Press the button to enter the system settings menu.
- Press the button again to exit the menu interface.
- Press the OK button to enter or confirm the settings.

Image Size (To set or reset the resolution of the photo):

Photo resolution options:

- 3M (2048 X 1536 pixels)
- 2M (1920 X 1080 pixels)
- 1.3M (1280 X 960 pixels)
- VGA (640 X 480 pixels)

Playback Mode:

- Enter playback mode as instructed earlier.
- Press the button to enter the playback settings menu.
- Use the buttons to select and highlight the function you would like to adjust. Press the OK Button to enter the subsequent menus.
- Press button to enter the System settings menu.
- Press button again to exit the menu interface.
- Press the OK Button to enter or confirm the settings.

9

PTO

Protect
The protect function protects a file from being erased accidentally. To delete a protected file, it must first be unlocked.

Delete
Deletes the current files, or all the files on the display as per the on-screen instructions.

Thumbnail
Lets you view your videos/images.

Beep Sound
To set the volume of the beep sound when a button is pressed.

- To upload photo/video files to your PC:**
1. Connect the Dash Cam to a computer using a Micro USB Data Cable. (Supplied separately)
 2. The unit will automatically power on and display USB modes: "Mass Storage" and "PC Camera"
 3. Press OK Button to choose "Mass Storage".
 4. Wait a few moments, the storage folder for the unit will appear on the computer screen.
 5. Follow the on-screen instructions to view, watch, upload or save the files to the PC.

NOTE:
Compatible computer operation system: Windows XP; Windows Vista; Windows 7; Windows 8 and Windows 10.

You can also disconnect the memory card from the Dash Cam and use a Card Reader to upload images/video to your computer.

Specification	
Sensor:	0.3 Mega pixel CMOS
Video Resolution:	720P 1280 x 720 pixels, 30 fps VGA 640 x 480 pixels, 30fps
Photo Resolution:	3M, 2048 x 1536 pixels 2M, 1920 x 1080 pixels 1.3M, 1280 x 960 pixels VGA, 640 x 480 pixels
Lens:	f = 3.0 mm, F = 2.0
Focus range:	1.2 m (4 ft) ~ infinity
Storage media:	Micro SD card (4-32 GB, class 10)
File format:	JPG/AVI
Power Source:	DC 5V through Micro USB Port, Or Built-in DC 3.7V, 110mAH (0.407WH) Li-ion Rechargeable Battery; Recharge by DC 5V via Micro USB port
I/O Port:	Micro USB 2.0/ TF (Micro SD Card) Slot
Screen:	1.5" color LCD display
Microphone:	Built-in Condenser Microphone
Speaker:	0.5 W, 8 ohm
COMPUTER SYSTEM REQUIREMENT:	
Operation System:	Microsoft Windows XP, Vista, 7, 8,10
CPU:	Intel Pentium III or greater
Memory:	More than 128 MB
Sound card & display:	Support Direct x8 or above
CD-ROM:	4X speed or above
Hard Disk:	500 MB useable
Other:	USB 2.0 port

PNGD3 01/2019V1
©2018 Pama England
E&OE All trademarks owned & operated by their respective companies.
Made in China
www.pama.com
Helpline: +44 (0) 161 494 4200