

WorkForce WF-2865DWF



Compact 4-in-1 designed for home and small offices, with double-sided printing, Wi-Fi, Ethernet and mobile printing².

You'll be surprised just how many essential business features this affordable and compact 4-in-1 inkjet packs in. Connect easily via Wi-Fi, Wi-Fi Direct and Ethernet, and print in the way that suits you with NFC¹, Epson Connect², Apple AirPrint³ and Google Cloud Print. Thanks to the automatic document feeder and double double-sided printing, you can use your time and budget more efficiently.

Compact and stylish

There's no need to waste space; the 4-in-1 WF-2860DWF features a compact design. With its sleek and refined form, it's easy to integrate this space-saving model into any home or small office setting.

Professional looking prints

Get high-quality prints thanks to Epson's most advanced printhead technology, PrecisionCore. It's renowned for its speed, quality, reliability and efficiency.

Easy to use

Speed through tasks using double-sided printing, 150-sheet front-loading paper cassette and 30-page ADF for multi-page scanning, copying and faxing. Navigation is intuitive thanks to the large LCD touch screen and new user interface. Store and share documents online by scanning directly to cloud storage sites², plus take advantage of the software included to create searchable PDFs from scans.

Affordable solution

Featuring individual inks, Epson's four-colour 502 ink provides reliable, vibrant and clear prints with minimal outlay. Reduce costs even further with Epson's XL pack, that can print 2.5x more pages⁴.

Get connected

Choose the connectivity solution that suits you with Wi-Fi, Wi-Fi Direct and Ethernet. Easily print documents from smart devices using NFC¹, Apple AirPrint³ and Google Cloud Print. Take advantage of Epson's free mobile printing solutions including Email Print, that can send items to print from almost anywhere in the world².

DATASHEET / BROCHURE

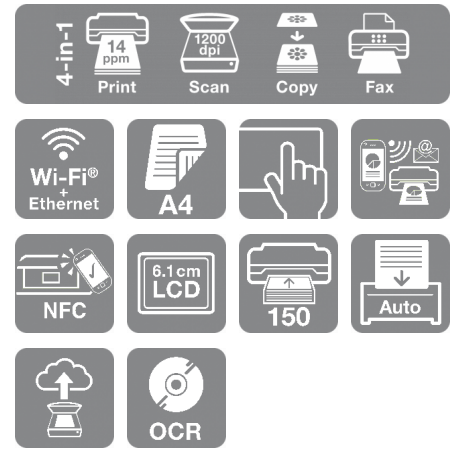

KEY FEATURES

- **Double-sided printing for business**
Use up to 50% less paper
- **Wi-Fi 4-in-1**
Scan, copy, print and fax wirelessly
- **Easy mobile printing**
Print easily from your smartphone or tablet²
- **Tap to connect with NFC**
Simply touch your Android device to the printer to start printing¹
- **Touchscreen control**
6.1cm colour LCD touchscreen

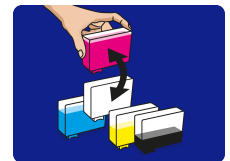

PRODUCT SPECIFICATIONS

TECHNOLOGY

Printing Method	PrecisionCore™ Print Head
Minimum Droplet Size	3.3 pl, With Variable-Sized Droplet Technology
Ink Technology	Pigment black and Dye colour Inks

PRINT

Printing Speed ISO/IEC 24734	14 pages/min Monochrome, 7.5 pages/min Colour
Duplex Printing Speed ISO/IEC 24734	6.5 A4 pages/min Monochrome, 4.5 A4 pages/min Colour
Maximum Printing Speed	33 pages/min Monochrome (plain paper), 20 pages/min Colour (plain paper)
Printing Resolution	4,800 x 1,200 dpi
Max Duty cycle	3,000 pages per month
	The maximum number of printed pages per month based on the performance capabilities of the printer, including ISO rated print speeds and paper handling capabilities.
Recommended Duty Cycle	200 - 800 pages per month
Colours	Black, Cyan, Yellow, Magenta

For detailed information on printing speeds please visit <http://www.epson.eu/testing>.

SCAN

Scanning Resolution	1,200 dpi x 2,400 dpi (Horizontal x Vertical)
Output formats	BMP, JPEG, PICT, TIFF, multi-TIFF, PDF
Scanner type	Contact image sensor (CIS)

FAX

Fax speed dials (max)	100 names and numbers
Page memory	upto 100 pages (ITU-T No.1 chart)
Fax Functions	PC Fax, Auto Redial, Address Book, Delay Send, Broadcast Fax

PAPER / MEDIA HANDLING

Paper Formats	A4, A5, A6, B5, C6 (Envelope), DL (Envelope), No. 10 (Envelope), Letter, Letter Legal, 10 x 15 cm, 13 x 18 cm, 16:9, User defined
Automatic Document Feeder	30 pages
Duplex	Yes (A4, plain paper)
Paper Tray Capacity	150 Sheets Standard
Number of paper trays	1

CONNECTIVITY

Interfaces	Ethernet interface (100 Base-TX / 10 Base-T), Wireless LAN IEEE 802.11b/g/n (WiFi 4), Wi-Fi Direct, Near Field Communication (NFC), Hi-Speed USB - compatible with USB 2.0 specification
------------	--

GENERAL

Energy Use	5.3 W (Ready), 0.2 W (Power off), 12 W (standalone copying, ISO/IEC 24712 pattern), 1 W (sleep mode)
------------	--

OTHER

Warranty	12 months Carry in Optional warranty extension available
----------	---

LOGISTICS INFORMATION

SKU	C11CG28403
EAN code	8715946649696
Country of Origin	Philippines
Layer	2 Units
Layer Block	4 Units



For more information please contact:

Home users: 0343 90 37766
Business users*: 0871 42 37766
Republic of Ireland: 01 436 7742
Or visit us at <https://www.epson.co.uk/contactus>
* 10p per minute plus network extras.

Web: www.epson.co.uk
www.epson.ie

Trademarks and registered trademarks are the property of Seiko Epson Corporation or their respective owners.
Product information is subject to change without prior notice.
Last extracted: 2018-10-19

WorkForce WF-2865DWF

WHAT'S IN THE BOX

- Warranty document
- Individual Ink Cartridges
- Main unit
- Setup guide
- Software (CD)
- Power cable

INK CARTRIDGE COMPATIBILITY



INK YIELD DATA



Binoculars
502XL

Binoculars
502

●	550 pages*	210 pages*
● ● ● ●	470 pages*	165 pages*

* Approx. page yield based on ISO/IEC 24711/24712 or ISO/IEC 29102/29103. Actual yield will vary depending on images printed and usage conditions. For more information visit <http://www.epson.eu/pageyield>

1. Requires NFC and Wi-Fi Direct enabled device with Android OS 4.0 or higher. Requires download of Epson iPrint app from Google Play.
2. For more information, please visit www.epson.eu/pageyield
3. Epson iPrint requires a wireless connection and the Epson printing app. Epson Email print, Epson Remote Print Driver and Epson scan-to-cloud require an internet connection. For more information, supported languages and devices, please visit www.epsonconnect.eu
4. AirPrint-enabled printers work with iPhone 4s and later, iPad 2 and later, all models of iPad Air and iPad mini, and iPod touch 5th generation with the latest version of iOS, and Mac with the latest version of OSX.
5. For more information, please visit www.epson.eu/pageyield

EPSON®